

Sun StorageTek™ 5220 NAS Appliance 設定說明

內容物

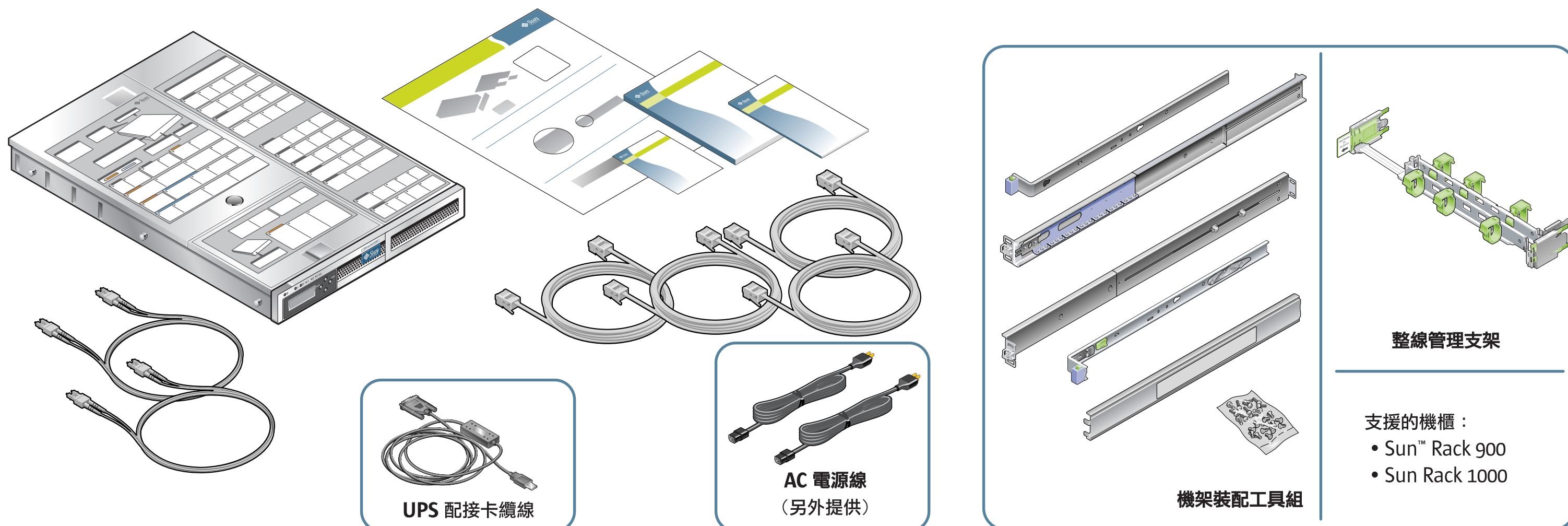

820-0203-10



如需選購裝置、安裝說明及開機程序的詳細資訊，
請參閱「Sun StorageTek 5220 NAS Appliance 入門指南」。

文件：http://www.sun.com/hwdocs/Network_Storage_Solutions/nas

前方面板控制

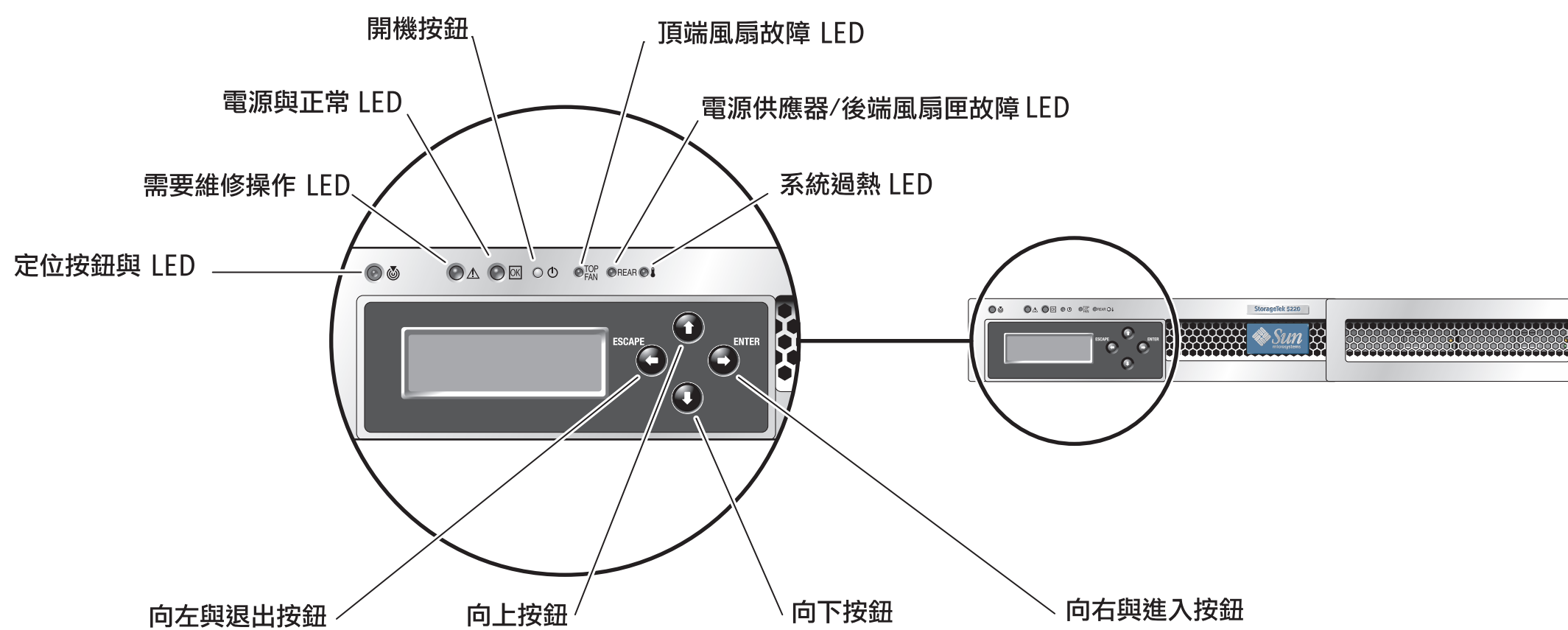

後方面板

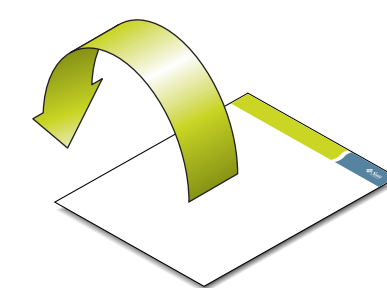
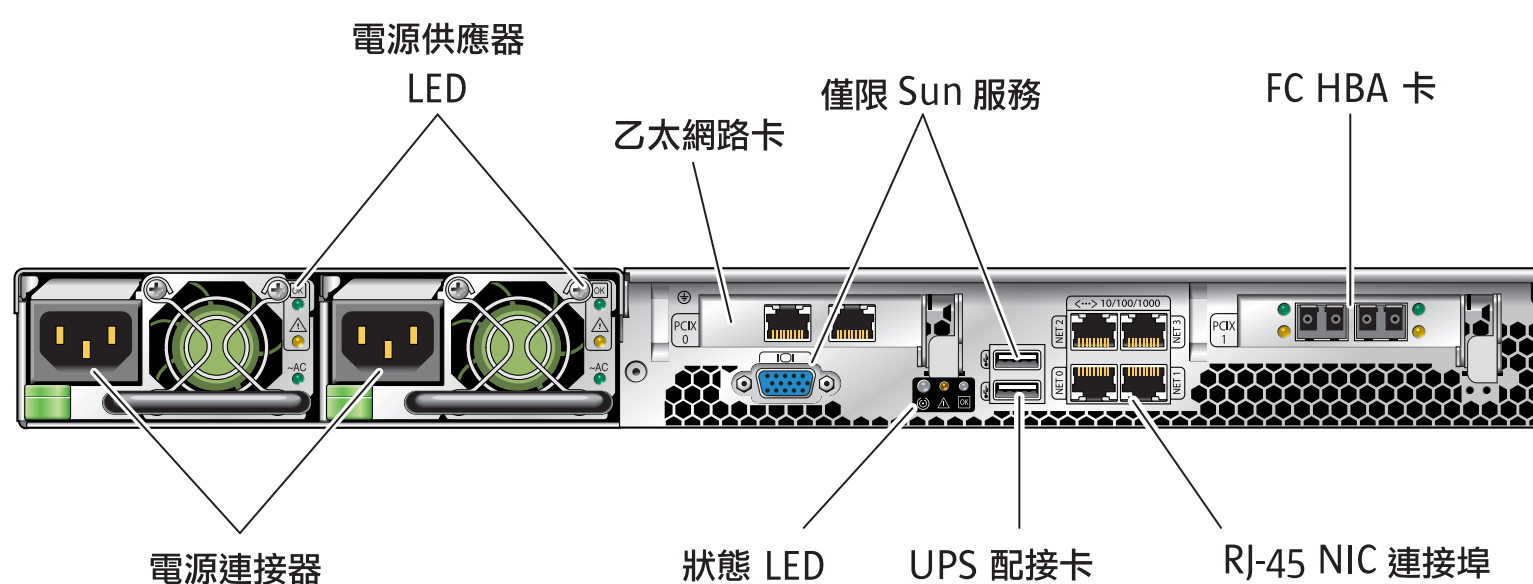

配置

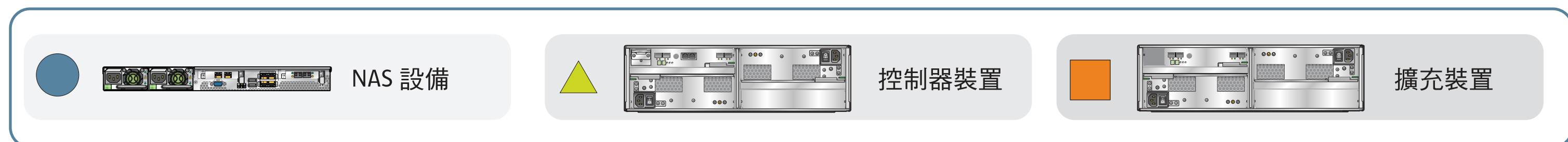
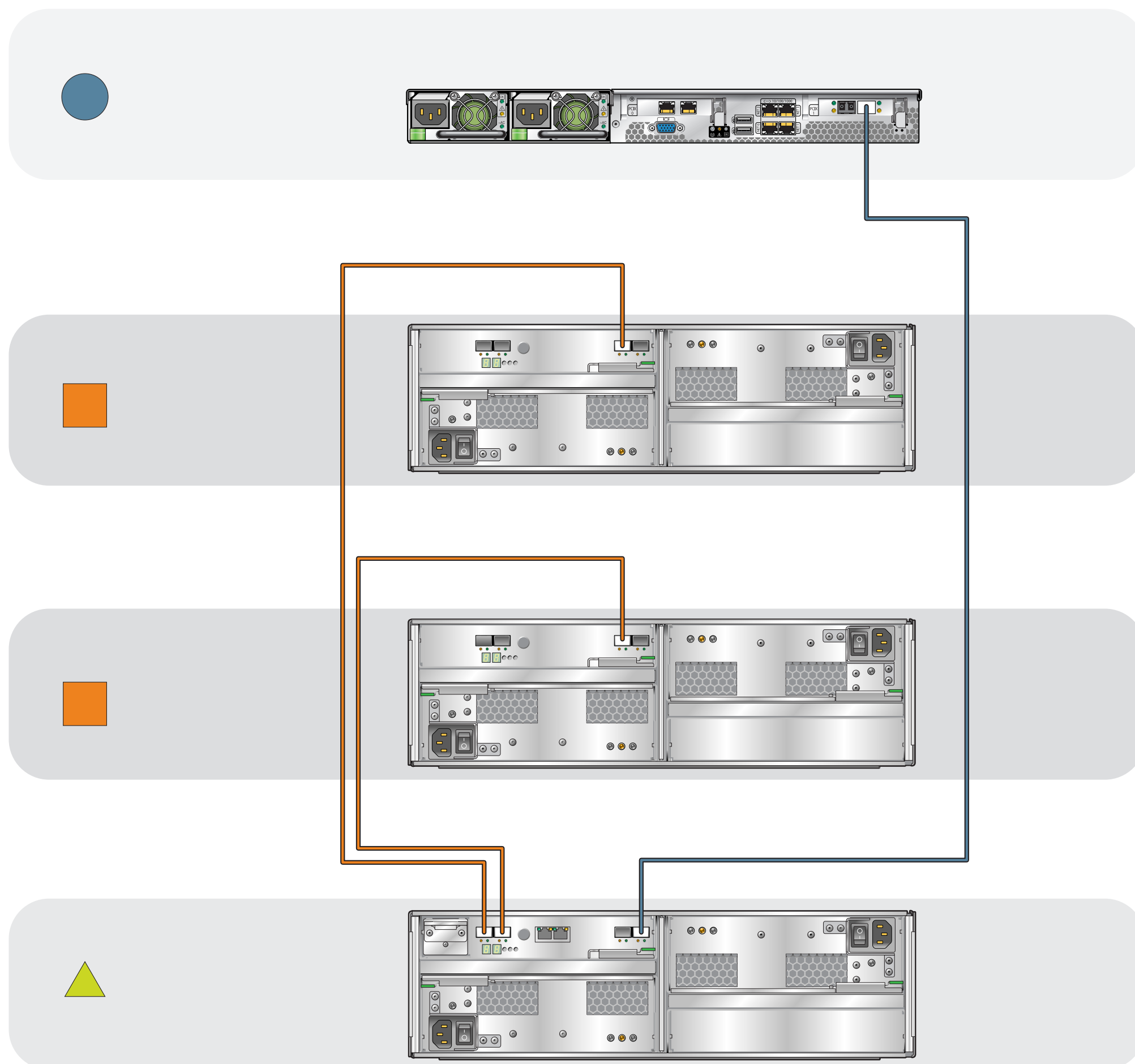

初始開機順序

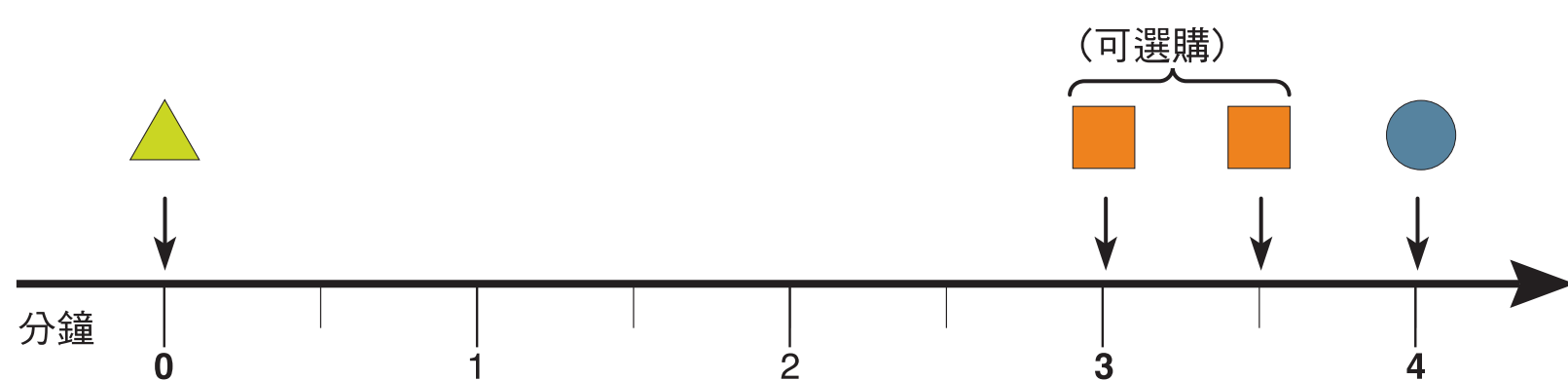

820-0203-10



http://www.sun.com/hwdocs/Network_Storage_Solutions/nas