

Технические характеристики (Русский)

Характеристика	Описание
Производитель и номер модели источника питания	Delta Electronics Inc. ADP- 36EH C
Выходные параметры пост. тока источника питания	3 A, 12 В
Рабочая высота над уровнем моря	3048 метров (10 000 футов)
Рабочая температура	От 0 до 40°C
Масса	660 г (1,46 фунта)

사양 (한국어)

사양	세부 내역
전원공급장치 제조사 및 모델 번호	Delta Electronics Inc. ADP- 36EH C
전원공급장치 DC 출력	3 암페어 12 볼트
사용 고도	10,000 피트 (3048 미터)
사용 온도	섭씨 0 ~40 도
무게	1.46 파운드 (660g)

仕様(日本語)

仕様	詳細
電源メーカーおよび型番	デルタエレクトロニクス社製 ADP-36EH C
電源 DC 出力	3A 12 V
限界高度	3048 m(10,000 フィート)
操作温度	0 ~40 C
重量	660g

规格(简体中文)

规格	详细信息
电源制造商及型号	台达电子股份有限公司 ADP- 36EH C
电源直流输出	3 安 12 伏
操作高度	10000 英尺 (3048 米)
操作温度	0 -40 摄氏度
重量	1.46 磅 (.660 公斤)

規格(繁體中文)

規格	詳細資料
電源供應器製造商和型號	台達電子股份有限公司 ADP- 36EH C
電源供應器 DC 輸出	3 安培，12 伏特
操作高度	10,000 英尺 (3048 公尺)
操作溫度	攝氏 0 至 40 度
重量	1.46 磅 (.660 公斤)

Copyright © 2010, 2013 Oracle and/or its affiliates. All rights reserved.

Oracle and Java are registered trademarks of Oracle and/or its affiliates. Other names may be trademarks of their respective owners.

Intel and Intel Xeon are trademarks or registered trademarks of Intel Corporation. All SPARC trademarks are used under license and are trademarks or registered trademarks of SPARC International, Inc. AMD, Opteron, the AMD logo, and the AMD Opteron logo are trademarks or registered trademarks of Advanced Micro Devices. UNIX is a registered trademark of The Open Group.

This software and related documentation are provided under a license agreement containing restrictions on use and disclosure and are protected by intellectual property laws. Except as expressly permitted in your license agreement or allowed by law, you may not use, copy, reproduce, translate, broadcast, modify, license, transmit, distribute, exhibit, perform, publish or display any part, in any form, or by any means. Reverse engineering, disassembly, or decompilation of this software, unless required by law for interoperability, is prohibited.

The information contained herein is subject to change without notice and is not warranted to be error-free. If you find any errors, please report them to us in writing.

If this is software or related documentation that is delivered to the U.S. Government or anyone licensing it on behalf of the U.S. Government, the following notice is applicable:

U.S. GOVERNMENT END USERS: Oracle programs, including any operating system, integrated software, any programs installed on the hardware, and/or documentation, delivered to U.S. Government end users are ?commercial computer software? pursuant to the applicable Federal Acquisition Regulation and agency-specific supplemental regulations. As such, use, duplication, disclosure, modification, and adaptation of the programs, including any operating system, integrated software, any programs installed on the hardware, and/or documentation, shall be subject to license terms and license restrictions applicable to the programs. No other rights are granted to the U.S. Government.

This software or hardware is developed for general use in a variety of information management applications. It is not developed or intended for use in any inherently dangerous applications, including applications that may create a risk of personal injury. If you use this software or hardware in dangerous applications, then you shall be responsible to take all appropriate failsafe, backup, redundancy, and other measures to ensure its safe use. Oracle Corporation and its affiliates disclaim any liability for any damages caused by use of this software or hardware in dangerous applications.

This software or hardware and documentation may provide access to or information on content, products and services from third parties. Oracle Corporation and its affiliates are not responsible for and expressly disclaim all warranties of any kind with respect to third-party content, products, and services. Oracle Corporation and its affiliates will not be responsible for any loss, costs, or damages incurred due to your access to or use of third-party content, products, or services.



Sun Ray 3 Client Getting Started Guide

Congratulations! Your Sun Ray 3 Client combines enhanced security, increased flexibility, and extreme performance with low power consumption and maintenance costs. And, it is ENERGY STAR 5.0 compliant.

What's in the Box?

Your shipping box includes a Sun Ray 3 Client, a base for vertical operation, a power supply (external universal AC/DC adapter), a power cord, and this Getting Started Guide (not shown). The keyboard and mouse are also included with an optional configuration.

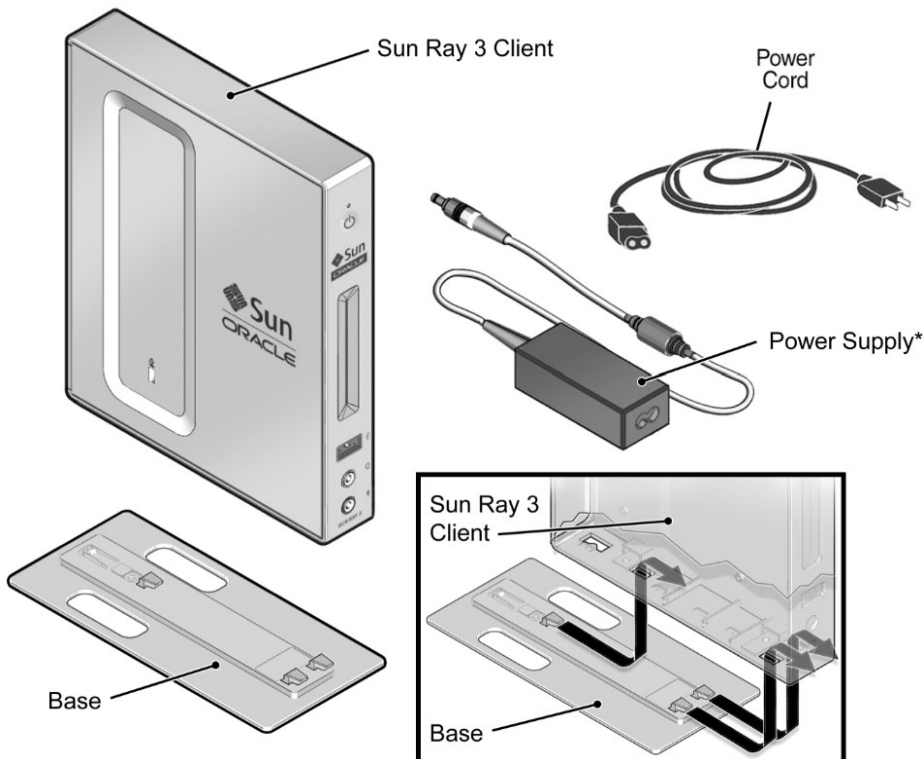

Note: To avoid electrical damage, use only the original equipment power supply.

Note: Attach the base for vertical operation.

Ports and Cables

The Sun Ray 3 Client ports are labeled below.

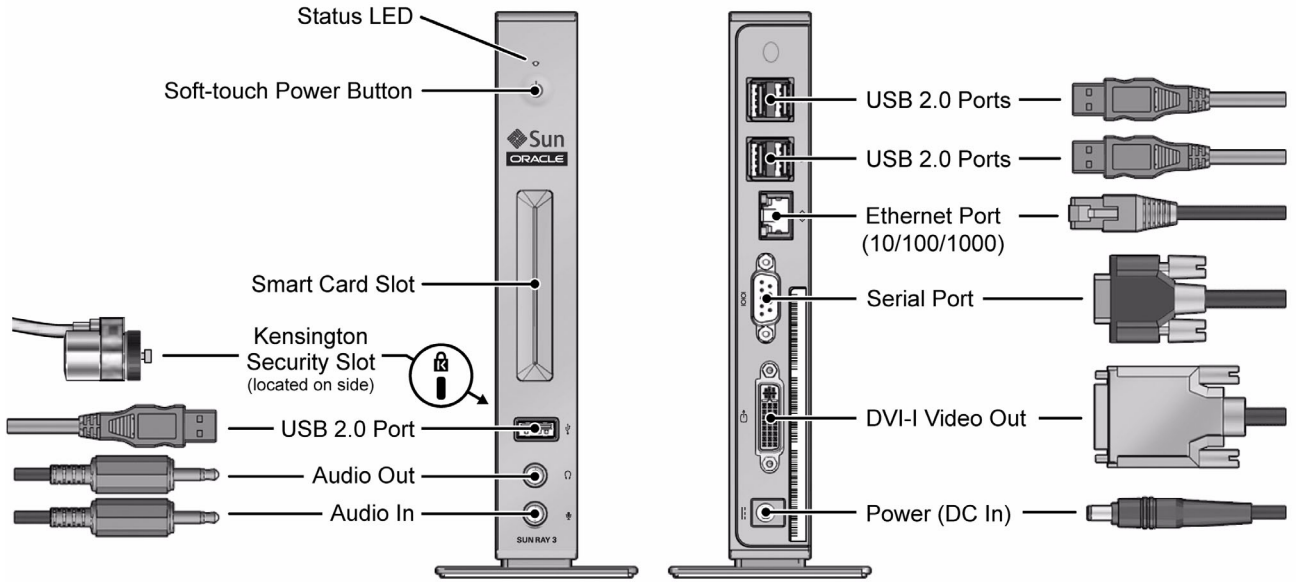

Setup

Cables are not supplied with this unit.

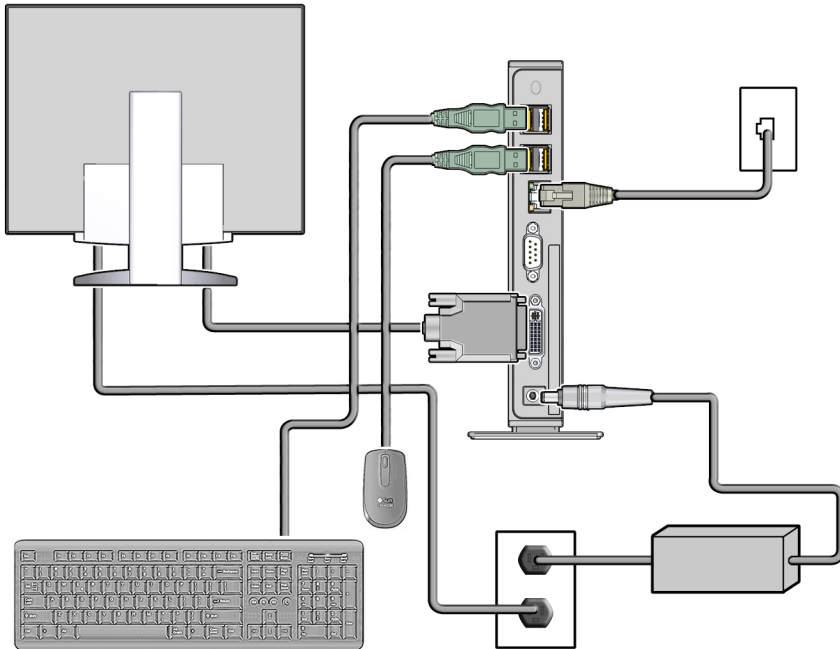

Note: To avoid glare, do not place the unit in front of a monitor.**

Operation

When the Sun Ray 3 Client is first plugged in, it powers on automatically.

To save energy, the unit powers off automatically when idle for 30 minutes. To power the unit on, touch the power button or insert a smart card.

Diagnostics

The following table describes the LED colors and states. If the Status LED is green, the unit is functioning normally.

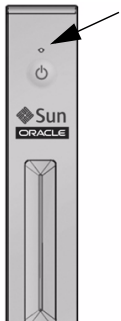
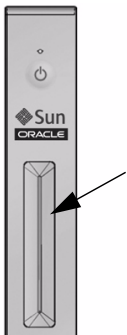
LEDs	State	Meaning
Status LED 	Off	The unit is not plugged in or not powered on. Note: Powering the unit off or removing a smart card does not affect the current session.
	Green	The unit is powered on and is functioning normally.
	Amber	The LED lights for 2-3 seconds or less at power-on while the unit performs diagnostic tests. If the LED remains amber or becomes amber at any other time, the unit may be inoperable and should be reset. To reset the unit, power it off and on by touching the power button or by unplugging and replugging the power cord. If the LED remains amber, continue to reset the unit two more times. If the LED remains amber after three resets, the unit is inoperable. Contact your system administrator to replace the unit.
Smart Card LED 	The LED in the smart card slot indicates whether a smart card is inserted and detected.	
	Off	No smart card is inserted or detected.
	On	The smart card has been inserted correctly.

Contacting Us

For additional Sun Ray 3 Client documentation, see:

- <http://oracle.com/technetwork/documentation/sun-ray-193669.html>

To contact technical support for this product, see:

- <http://support.oracle.com>

Specifications

Specification	Detail
Power Supply Manufacturer and Model Number	Delta Electronics Inc. ADP-36EH C
Power Supply AC Input	1 Amp 100-240 V 50-60Hz
Power Supply DC Output	3 Amps 12 V (Max)
Operating Altitude	10,000 feet (3048 meters) (Max)
Operating Temperature	0° to 40° C
Weight (with base)	1.46 lb (660 g)

Spécifications

Spécifications	Détails
Fabricant d'alimentation et Numéro de modèle	Delta Electronics Inc. ADP- 36EH C
Sortie CC de l'alimentation	3 A - 12 V
Altitude de fonctionnement	10,000 pieds (3048 mètres)
Température de fonctionnement	0 à 40 degrés C
Poids	1,46 livres (660 g)

Especificaciones

Specification	Detalles
Fabricante de fuentes de alimentación y número de modelo	Delta Electronics Inc. ADP- 36EH C
Salida DC de la fuente de alimentación	3 Amperios 12 Voltios
Altitud en funcionamiento	10.000 pies (3048 metros)
Temperatura en funcionamiento	0 a 40 grados C
Peso	1,46 libras (660 g)

* Fuente de Alimentacion

Utilice solo adaptadores con las siguientes características eléctricas y que estén debidamente certificados de acuerdo a la legislación vigente. El uso de otros adaptadores podría dañar el dispositivo y anular la garantía además de provocar riesgos al usuario.

Entrada AC: 100 a 240 VAC, 50 o 60 Hz, 1 A max
Salida DC: 12 V, 3 A

Specifiche

Specifiche tecniche	Dettagli
Produttore dell'alimentatore e numero del modello	Delta Electronics Inc. ADP- 36EH C
Tensione di uscita dell'alimentatore	3 Amp 12 Volt
Altitudine di funzionamento	10.000 piedi (3048 metri)
Temperatura di funzionamento	Da 0 a 40 C°
Peso	1,46 libbre (660 g)

Spezifikationen

Spezifikation	Technisches Detail
Netzteilhersteller und Modellnummer	Delta Electronics Inc. ADP- 36EH C
Netzteil Ausgang (DC)	3 A 12 V
Betriebshöhe über NN	3048 Meter (10,000 Fuß)
Betriebstemperatur	0 °C bis 40 °C
Gewicht	660 g (1.46 Pfund)

Oracle Support

Oracle Geschäftsstelle Berlin
Stadtteil Tegel
Schloßstraße 2
D - 13507 Berlin
Telefon +49 30 43 57 95-0
Telefax +49 30 43 57 95-119

Für technische Anfragen bei gültigem Wartungsvertrag:

0180 2000 170
0800 000 1659
servicecontracts_de@oracle.com

** Achtung

Das Gerät ist nicht für die Benutzung im unmittelbaren Gesichtsfeld am Bildschirmarbeitsplatz vorgesehen.

Um störende Reflexionen am Bildschirmarbeitsplatz zu vermeiden, darf dieses Produkt nicht im unmittelbaren Gesichtsfeld platziert werden.