

NOTES: UNLESS OTHERWISE SPECIFIED

- 1) NO ADDITIONS, DELETIONS, SUBSTITUTIONS OR MODIFICATIONS WITHOUT PRIOR WRITTEN TEKELEC APPROVAL.
- 2) TORQUE ALL FASTENERS IN ACCORDANCE WITH TEKELEC SPECIFICATION 906-0008-01.
- 3) REFER TO INTERCONNECT DIAGRAM (ITEM 15) FOR CABLE CONNECTIONS.
- 4) FOR LOCATING INDIVIDUAL PARTS, USE DIMENSION SHOWN.
- 5) DO NOT INSTALL. SHIP UNASSEMBLED AND PACKED WITH UNIT.
- 6) LABEL SHOWN IS PART OF ITEM 15. POSITION AS SHOWN.
- 7) UNLESS OTHERWISE SPECIFIED, ITEMS NOT SHOWN TO BE SHIPPED PACKED WITH UNIT.
- 8) LOCATE APPROXIMATELY AS SHOWN.
- 9) CABINET MOUNTING HARDWARE IS SUPPLIED WITH CABINET (ITEM 22). THERE IS A QUANTITY OF 50 CAPTIVE NUTS (6mm) AND 100 PHILLIPS PAN HEAD SCREWS 6mm x 16mm. THE CAPTIVE NUTS SHOULD BE INSTALLED FROM THE INSIDE OF THE CABINET AND ARE USED TO SECURE ALL COMPONENTS AND ASSOCIATED HARDWARE TO THE VERTICAL MOUNTING RAILS AS SHOWN IN DETAIL D. SHIP UNUSED NUTS AND SCREWS WITH UNIT.
- 10) USING BLANK LABEL PN 903-0122-01 ADD THE FOLLOWING PRINTING TO THE LABEL: (SEE DETAIL K) AND INSTALL IT OVER EXISTING TEXT ON LABEL.
3600 WATTS
- 11) INTERMEDIATE VERTICAL RAIL IS FOR MOUNTING PDU UNITS.
- 12) INSTALL OPTIONAL COMPONENTS AS REQUIRED.
- 13) REMOVE AND DISCARD TAB SUPPLIED WITH WRIST STRAP GROUND POINT (NOT SHOWN).
- 14) ATTACH CHASSIS GROUND CABLE WITH MOUNTING HARDWARE SUPPLIED WITH CABINET TWO NUTS AND TWO SCREWS, BOTH NOT SHOWN.
- 15) RACK DOLLY, FOR SHIPPING ONLY. TO BE REMOVED DURING INSTALLATION.
- 16) USING BLANK LABEL PN 617-0011-01 ADD THE FOLLOWING PRINTING TO THE LABEL: (SEE DETAIL J) AND INSTALL IT OVER EXISTING TEXT ON LABEL.
220 - 240 VAC
47-63 HZ
- 17) ITEM 6 IS USED TO LABEL CABLES. SEE SYSTEM INTERCONNECT FOR INFORMATION TO PRINT LABELS.
- 18) OPERATING KEY'S FOR SERVERS, NAS AND CABINET NOT SHOWN. KEY'S TO BE PACKAGED AND SHIPPED WITH ASSEMBLY AND LABELED.
- 19) THIS IS A CONFIGURABLE SYSTEM THE SALES ORDER WILL SPECIFY THE PART NUMBER'S AND QUANTITIES MAX CONFIGURATION AS SHOWN. (SEE SYSTEM INTERCONNECT FOR ADDITIONAL DETAILS)
- 20) INSTALL LOGIC GROUND TERMINAL BLOCK USING 2 (ITEM 28) 601-0010-01 SCREWS. INSTALL TERMINAL BLOCK WITH MOUNTING SCREWS THROUGH THE TOP HOLES OF THE TERMINAL BLOCK AND THROUGH THE VERTICAL RAIL THROUGH HOLES APPROX AS SHOWN.
- 21) INSTALLATION MOUNTING KIT ITEM 29 NOT SHOWN TO BE PACKAGED AND SHIPPED WITH CABINET.
- 22) REMOVE RAIL MOUNTING SCREW AND SECURE THE FRAME GROUND CABLES FROM PDU A AND B.

REVISIONS			
REV	DESCRIPTION	DATE	APPROVED
A	RELEASE PER ECN #14089	XXXX	ARMSTRONG
B	REVISED PER ECO #14156	1209/04	ARMSTRONG
C	REVISED PER ECO #14749	06/20/05	ARMSTRONG

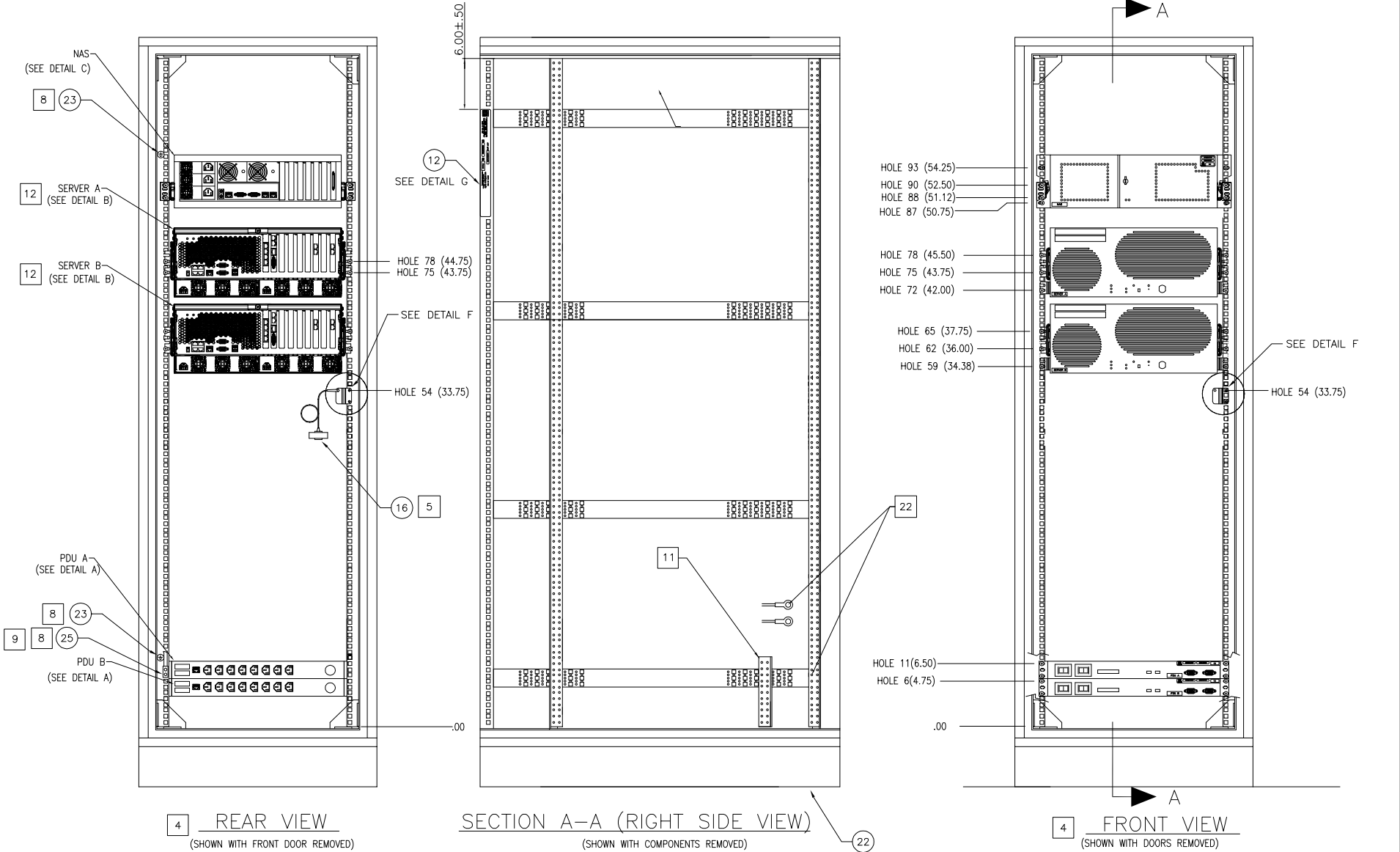

4 REAR VIEW
(SHOWN WITH FRONT DOOR REMOVED)

SECTION A-A (RIGHT SIDE VIEW)
(SHOWN WITH COMPONENTS REMOVED)

4 FRONT VIEW
(SHOWN WITH DOORS REMOVED)

DESCRIPTION	BOM PART NO.
LSMS_TKSERVER AC_FRAME ASSY	890-1836-01
BOM TABLE	

UNLESS OTHERWISE SPECIFIED: DO NOT SCALE DRAWING. DIMENSIONS ARE IN INCHES. INTERPRET DIMENSIONS IN ACCORDANCE WITH ASME Y14.5M-1994. DRAWING TO CONFORM TO TEKELEC SPECIFICATION 907-0169-01. DEBURR AND BREAK SHARP EDGES AND CORNERS .005-.015. MACHINED SURFACE FINISH \sqrt{R} DECIMAL TOLERANCES: XXX ±.02 XXX±.010 ANGLE TOLERANCE: ± 1'		THIS DOCUMENT AND THE DATA DISCLOSED HEREIN OR HEREWITH IS PROPRIETARY AND IS NOT TO BE REPRODUCED, USED OR DISCLOSED IN WHOLE OR PART TO ANYONE WITHOUT THE WRITTEN PERMISSION OF TEKELEC. COPYRIGHT TEKELEC 2001.		26580 W. Agoura Road, Calabasas, California 91302	
APPROVALS		DATE		DWG_GEN_LSMS_	
DRAWN BY M. BRYAN		11/4/04		TEKSERVER AC FRAME ASSY	
CHECKED <i>Beauchamp</i>		11/24/04		SIZE DIVISION DRAWING NO. REV.	
APPROVED J.ARMSTRONG		11/24/04		D NSD 890-1838-01 C	
FINISH		MATERIAL		SCALE: 1/1 FILE NAME: 890-1838-01_REV_C.DWG SHEET 1 OF 2	

